



Fair-Surface type with no protrusion of snap or hinge parts

Feature

- Split cores with plastic housing for easy installation on wired cables and cables with connectors.
- Cable tie fixture enables assistance of wire bundling and fixing on harness. (Except GRFC-3/4, RFC-H13, RFC-20)
- Harness guide provides easy harness winding and prevents pinching.

Material

- Ferrite Core: Soft ferrite
- Housing: PA66 (Color: Light gray / Flammability: UL94V-0)

Unit: mm

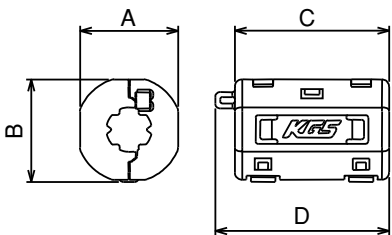

Part No.	A	B	C	D	Applicable cable diameter	Impedance* Ω/100MHz (1 turn)
GRFC-3	13.7	13.5	18.0	—	φ 2.5~3.5	≧ 35
GRFC-4	13.7	13.5	27.5	—	φ 3.5~4.5	≧ 75
GRFC-5	18.1	18.4	31.5	35.5	φ 4.5~5.5	≧ 100
GRFC-6	18.1	18.4	31.5	35.5	φ 5.5~6.5	≧ 100
GRFC-8	20.1	20.4	31.5	35.5	φ 7.5~8.5	≧ 75
GRFC-9	20.1	20.4	31.5	35.5	φ 8.5~9.5	≧ 75
GRFC-10	26.3	26.4	32.4	37.2	φ 9.5~10.5	≧ 105
GRFC-13	29.1	29.4	31.5	36.3	φ 12.5~13.5	≧ 95
GRFC-7	14.25	15.8	20.0	24.0	φ 7max	≧ 45
RFC-H13	31.7	29.4	41.0	—	φ 12.5~13.5	≧ 170
RFC-20	40.0	40.0	47.0	—	φ 20max	≧ 180



RFCK2-20 (RFC-20 with mounting fixture is available. Contact us for the details.)

*Contact us for the measurement conditions.

*The values are measured data for reference, not guaranteed.

GRFC-3

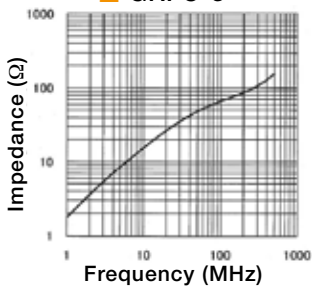

GRFC-4

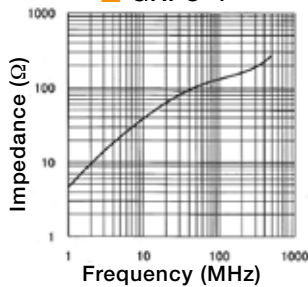

GRFC-5

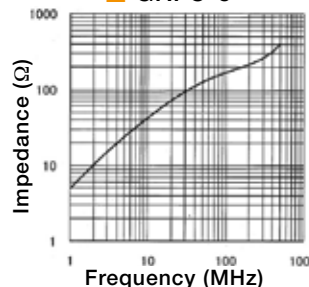

GRFC-6

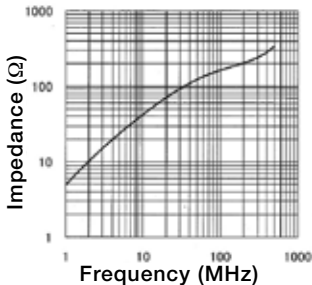

GRFC-7

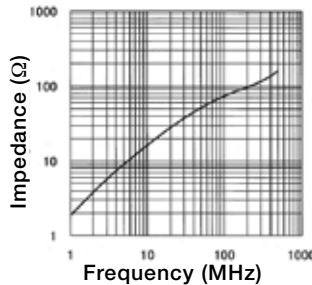

GRFC-8

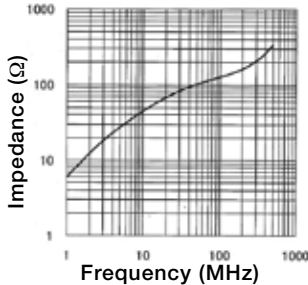

GRFC-9

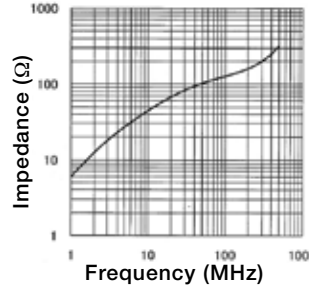

GRFC-10

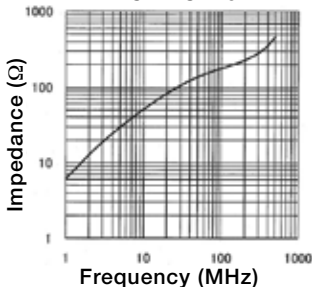

GRFC-13

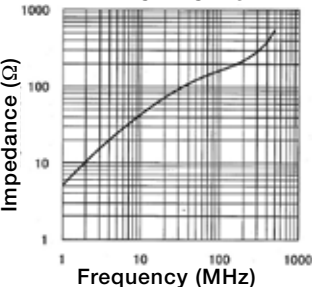

RFC-H13

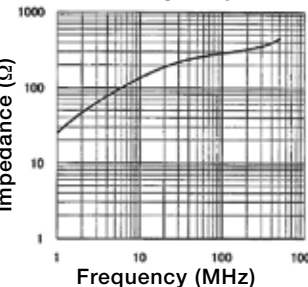

RFC-20

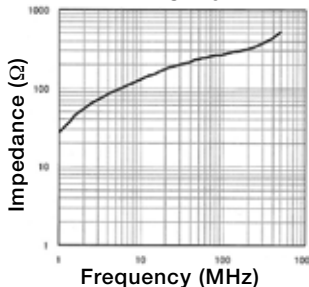



Split cores with plastic housing for easy installation on wired cables

Feature

- Not easily removed once the lock part is fastened.

Material

- Housing / Nylon 66 (Light gray / UL94V-0, Black* / UL94V-2)
Black type has "BK" at the end of the part number. (Applied to SFC-3 only)
- Core / Soft ferrite

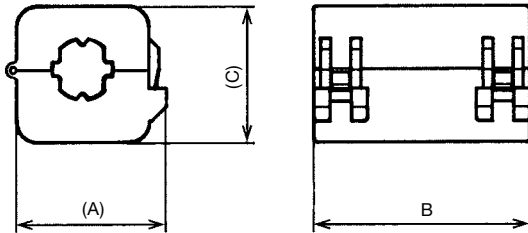

SFC-3 and 4 have different configurations. Contact us for the details.

Unit: mm

Part No.	(A)	(B)	C	Applicable cable diameter	Impedance* Ω /100MHz (1 turn)
SFC-3	12.7	18.9	13.2	ϕ 3.0~4.0	\geq 45
SFC-4	15.0	29.5	15.0	ϕ 4.0~5.0	\geq 85
SFC-5	19.5	32.0	17.5	ϕ 5.0~6.0	\geq 140
SFC-6	22.0	32.0	20.0	ϕ 6.0~7.0	\geq 120
SFC-8	22.0	32.0	20.0	ϕ 7.5~8.5	\geq 120
SFC-10	31.0	32.0	29.0	ϕ 9.5~10.5	\geq 140

*Contact us for the measurement conditions.

*The values are measured data for reference, not guaranteed.

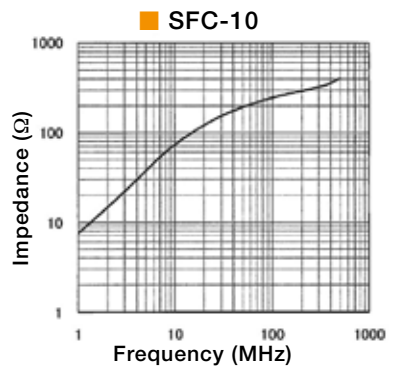
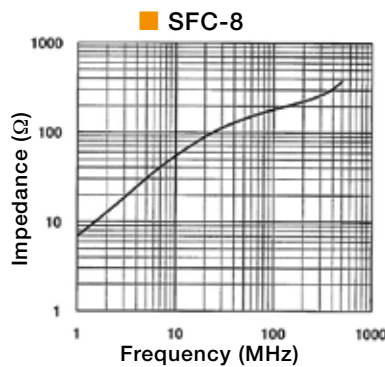
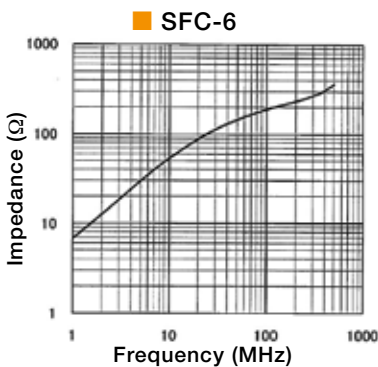
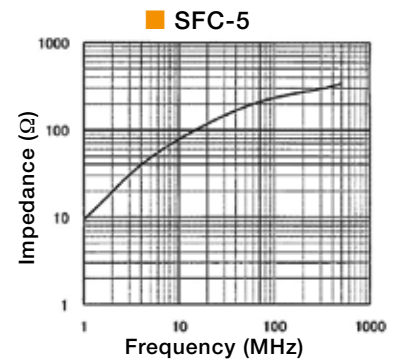
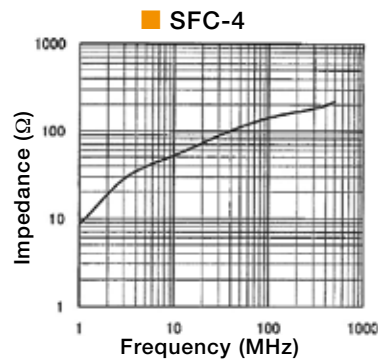
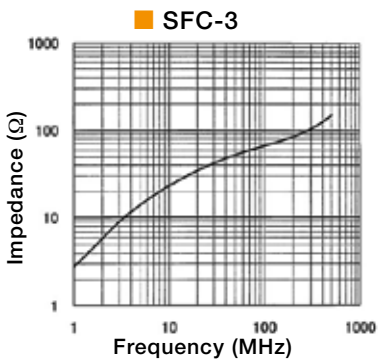

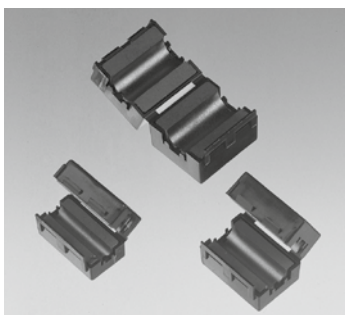

Split cores with plastic housing for easy installation on wired cables

Feature

- Split construction permits easy insertion on pre-installed cable and installed or cables with connectors.
- Kept in a plastic case, ferrite will not crack or chip. (UL 94 V-2)
- Cable is fixed firmly by plastic housing

Applications

- For noise problems arising from office automation equipment or other digital equipment.
- Internal and external power cable.
- Internal cables between PC boards and data connectors.
- White Plastic case available.

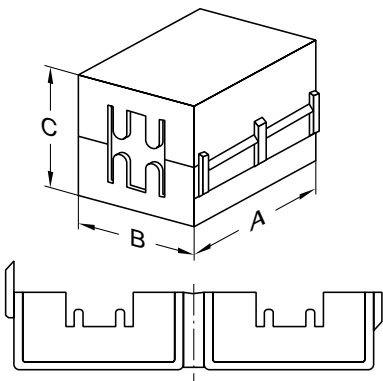

Unit: mm

Part No.	(A)	(B)	C	Max. cable diameter	Impedance* (Ω) 25MHz	Impedance* (Ω) 100MHz
KCF-50	23.0	15.0	14.0	∅5.0	93	157
KCF-65	32.6	17.8	19.2	∅6.5	176	267
KCF-100	32.6	22.5	23.0	∅10.0	151	226
KCF-130	32.7	29.2	30.2	∅13.0	152	228

*Contact us for the measurement conditions.

Impedance vs frequency properties*

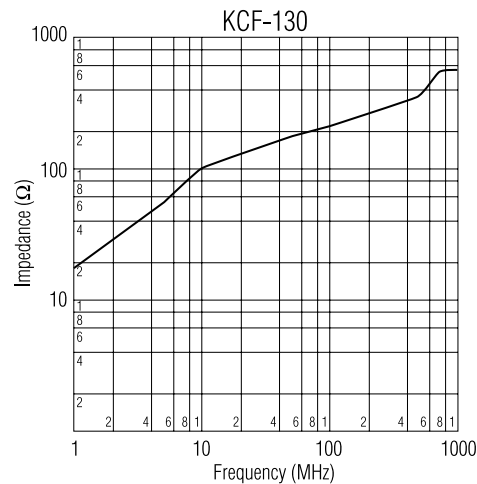
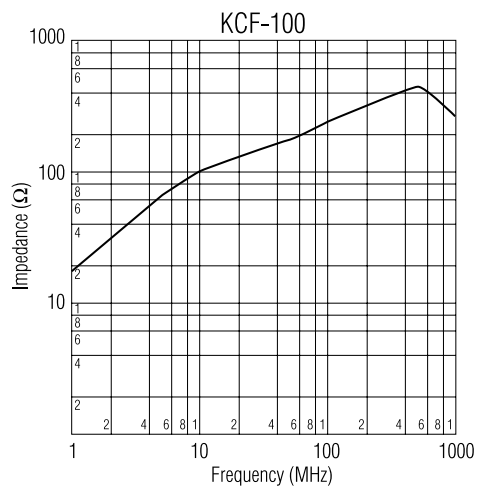
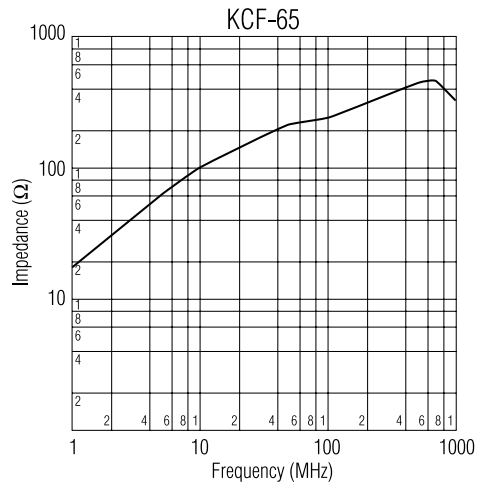
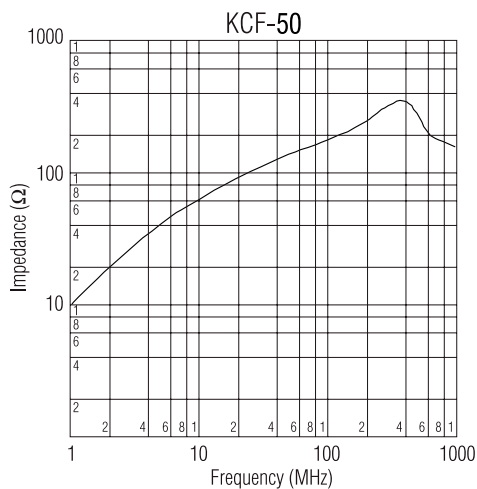

*The values are measured data for reference, not guaranteed.

TOROIDAL CORE/GTRCN



Clamp integrated type provides easy assembly

Feature

- Split design allows easy assembly on wired or connected cables, in single or multiple turn specifications.

Material

- Clamp / 66 Nylon 66 / (Natural color / UL94V-2)
- Core / Soft ferrite

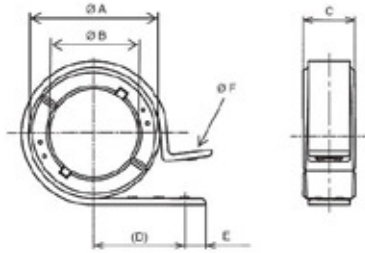

Schematic drawing

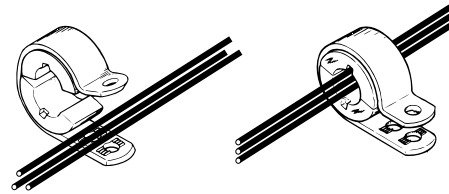

Unit: mm

Part No.	øA	øB	C	(D)	E	øF	Applicable cable diameter	Impedance* /100MHz (1 turn)
GTRCN-16-8-13	16.3	8.0	13.1	15.9	4.8	4.3	7,6 max	45
GTRCN-16-8-16	16.3	8.0	15.9	15,8	4.8	4.3	7,6 max	55
GTRCN-20-10-10	20.4	10.6	10.0	19.0	6.3	5.1	9,8 max	40
GTRCN-23-11-14	23.8	11.6	14.0	19.8	6.3	5.1	10,8 max	55
GTRCN-28-16-13	28.4	16.6	13.0	23.0	6.3	5.1	15,6 max	50
GTRCN-28-16-20	28.4	16.6	20.0	23.0	6.3	5.1	15,6 max	70
GTRCN-40-27-15	40.4	27.4	16.0	27,8	6.3	5.1	26,5 max	50

*Contact us for the measurement conditions.

TOROIDAL CORE/TRCA



Core with plastic housing prevents cracking or chip out of ferrite

Feature

- Provided with a plastic housing to prevent cracking or chipping of the ferrite.

Material

- Housing / Nylon 6 (Light gray / UL94V-0)
- Core / Soft ferrite

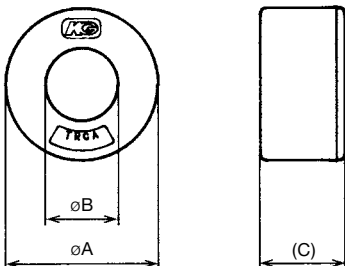

Unit: mm

Part No.	øA	øB	(C)	Impedance* Ω/100MHz (1 turn)
TRCA-20-10-10	22.6	8.2	13.3	≥50
TRCA-25-15-12	27.3	13.1	15.2	≥50

*Contact us for the measurement conditions.



Split cores with plastic housing for easy installation on wired cables

Usage

- Harness guide provides easy harness winding and prevents pinching. TFC-***** excluded.
- New hinge allows no protrusion. TFC-***** excluded.

Material

- Housing / Nylon 66 (Light gray / UL94V-0)
- Plate spring / Stainless steel (TFC-***** type only)
- Core / Soft ferrite

TFC-*****

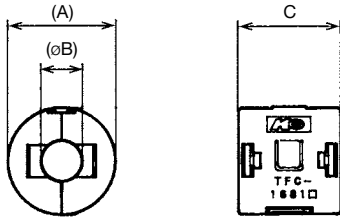

[Feature]

Space-saving simple configuration without protrusion of hinge part.

Unit: mm

Part No.	(A)	(B)	C	Applicable cable diameter	Impedance* Ω/100MHz (1 turn)
TFC-16813	19.8	7.6	18.9	ø7.2max	≥60
TFC-16816	19.8	7.6	21.9	ø7.2max	≥75

*Contact us for the measurement conditions.

TFCM-*****

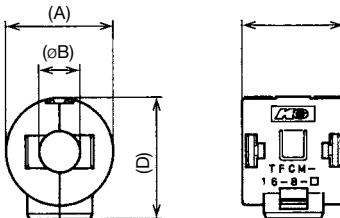

[Feature]

- Optional fixture available (refer to P 31-TFP)

Unit: mm

Part No.	(A)	(øB)	C	(D)	Applicable cable diameter	Impedance* /100MHz (1 turn)
TFCM-16-8-13	19.8	7.6	18.9	22.3	ø7.2max	60
TFCM-16-8-16	19.8	7.6	21.9	22.3	ø7.2max	75

*Contact us for the measurement conditions.

TFCM-41-27-16

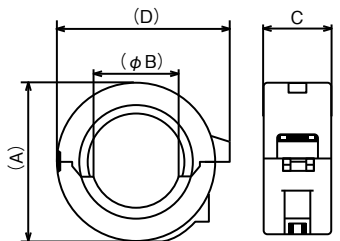

[Feature]

- Suitable for bundle diameter up to ø26mm.
- TFCK series come with pre-attached fixture for on enclosure, etc.

Unit: mm

Part No.	(A)	(øB)	C	(D)	Applicable cable diameter	Impedance* Ω/100MHz (1 turn)
TFCM-41-27-16	44	26.6	19.6	48.2	ø26max	≥60

*Contact us for the measurement conditions.

TFC-*****

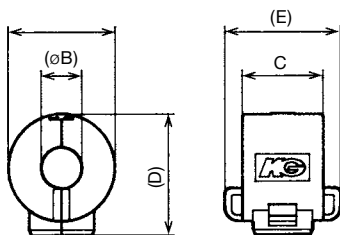

[Feature]

- Optional fixture available (refer to P 31-TFP).
- Incorporated with a metal spring.

Unit: mm

Part No.	(A)	(øB)	C	(D)	(E)	Applicable cable diameter	Impedance* Ω/100MHz (1 turn)
TFC-20-10-10	24.2	8.8	13.5	26.7	19.9	ø8.5max	≥50
TFC-23-11-14	27.4	10.8	17.5	29.9	23.9	ø10.5max	≥70
TFC-25-15-12A	28.2	13.6	13.7	30.9	20.1	ø13.0max	≥40

*Contact us for the measurement conditions.

TOROIDAL FERRITE CLAMP/TFCK



Ferrite clamps with mounting fixture for mounting on equipment

Usage

- Can be assembled on equipment using M4 screws.
- Easy installation on wired or connected cables, as well as easy harness winding.

Material

- Housing / Nylon 66 (Light gray / UL94V-0)
- Plate spring / Stainless steel (TFCM-41-27-16 excluded. TFC-***** type only)
- Core / Soft ferrite

TFCK-*****

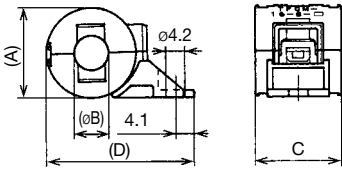

Unit: mm

Part No.	(A)	(B)	(C)	(D)	Applicable cable diameter	Impedance* Ω/100MHz (1 turn)
TFCK-16813	19.8	7.6	18.9	32.7	φ7.2max	≥60
TFCK-16816	19.8	7.6	21.9	32.7	φ7.2max	≥75

*Contact us for the measurement conditions.

TFCK-*****

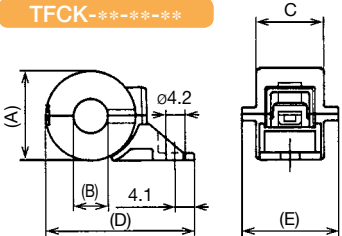

Unit: mm

Part No.	(A)	(B)	(C)	(D)	(E)	Applicable cable diameter	Impedance* Ω/100MHz (1 turn)
TFCK-20-10-10	24.2	8.8	13.5	37.0	19.9	φ8.5max	≥50
TFCK-23-11-14	27.4	10.8	17.5	40.7	23.9	φ10.5max	≥70
TFCK-25-15-12A	28.2	13.6	13.7	40.7	20.1	φ13.0max	≥40
TFCK-41-27-16	44.0	26.6	19.6	51.9	-	φ26.0max	≥60

*Contact us for the measurement conditions.

OPTIONAL COMPONENT/TFP



Fixture for the toroidal ferrite cores

Feature

- Applicable to our products, TFC-***** and TFCM-***** (TFCM-41-27-16 excluded.)
- Quick snap-in mounting of the housing (refer to Fig.1)
- No special tool required for removal, only a flathead screwdriver (refer to Fig. 2)

Material

- Nylon 66 (Light gray / UL94V-0)

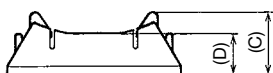
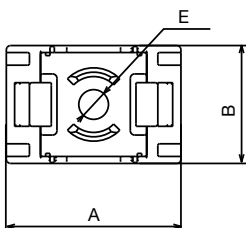
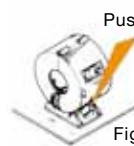

Fig.1



Pushing the lock knob for removal.

Fig.2

Unit: mm

Part No.	A	B	C	(D)	(E)	Note
TFP2014-V	20	13.5	7.2	4.8	φ3.4	M3 screw
TFP2014-T	20	13.5	7.2	4.8	φ3.4	Attached with double-sided adhesive tape (thickness 1mm)



Re-usable type, special fixture enables detachment with one hand, no tool required

Material

- Housing / Nylon 66 (Light gray / UL94V-0)
- Plate spring / Stainless steel (TFCM-41-27-16 excluded. TFC-***-**** type only)
- Core / Soft ferrite

TFCR-****

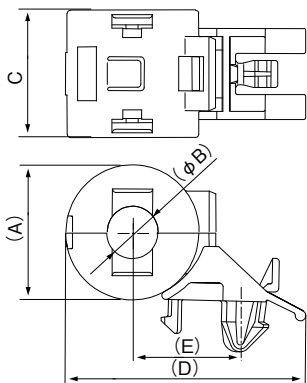

TFCR-****-****

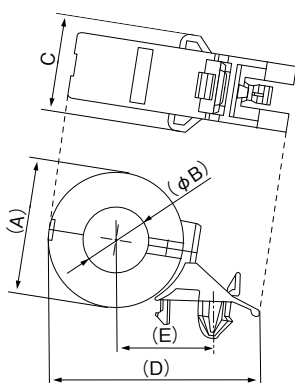

Unit: mm

Part No.	(A)	(φB)	C	(D)	(E)	Applicable cable diameter	Impedance* Ω/100MHz (1 turn)
TFCR-16813	19.8	7.6	18.9	36.0	16.5	φ7.2max	≥60
TFCR-16816	19.8	7.6	21.9	36.0	16.5	φ7.2max	≥75

*Contact us for the measurement conditions.

Mounting specifications

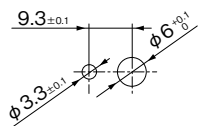

Board thickness : t0.8 ~ 2

Unit: mm

Part No.	(A)	(φB)	C	(D)	(E)	Applicable cable diameter	Impedance* Ω/100MHz (1 turn)
TFCR-20-10-10	24.2	8.8	19.9	40.3	17.4	φ8.5max	≥50
TFCR-23-11-14	27.4	10.8	23.9	44.0	19.6	φ10.5max	≥70
TFCR-25-15-12A	28.2	13.6	20.1	44.0	20.2	φ13.0max	≥40
TFCR-41-27-16	44.0	26.6	19.6	55.2	23.6	φ26.0max	≥60

*Contact us for the measurement conditions.

Lever for attachment and detachment

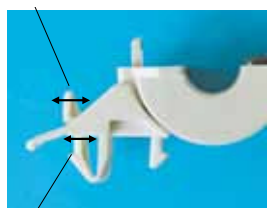

Snap fastener for reuse

Attaching

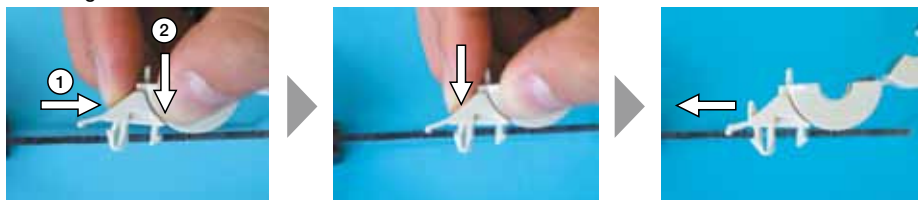

Detaching

